



ENERGY FACT SHEET:

BIG STONE SOUTH TO BROOKINGS TRANSMISSION PROJECT

QUICK FACTS

DEVELOPERS	Otter Tail Power Company and Xcel Energy
LINE CAPACITY	345 kV
ROUTE	Connects substation near Big Stone City, SD to substation near Brookings, County, SD



STATED PURPOSE

- Improve electrical reliability in the region.
- Increase access to and development of wind energy in the region.

ROUTE DESCRIPTION AND DETAILS

- Route will run from the Big Stone South substation near Big Stone City, SD to a substation in Brookings County, SD.
- Initial 28 miles of the line from the Brookings substation to a location near Gary, SD was approved years earlier.
- Targeted in-service date for the line is 2017.

CLEAN ENERGY & ECONOMIC DEVELOPMENT POTENTIAL

- The project will increase the essential transmission capacity that is required to develop wind energy in the area.
- An University of Minnesota Duluth economic impact study estimates that CapX projects would create 8,000 construction jobs in the region.
- The study also notes that each \$1 invested in the project is estimated to return \$1.93 to the economy.

COMMUNITY FEEDBACK

- Two rounds of open house meetings were held in 2012, with nearly 4,000 landowners contacted.

REGULATORY PROCESS

- Must acquire a facility permit from the South Dakota Public Utilities Commission before construction process can begin.
- Any local siting in the transmission projects is preempted in South Dakota by permitting from the state Department of Transportation and some other state agencies.
- Developers will provide regulators with at least one preferred and alternate route for approval.
- After submission of the permit application, there is automatic approval after one year.

DOCKET FILING

- The application for a facility permit in South Dakota can be viewed here: <http://www.capx2020.com/bss/BSS-FinalApp28May2013.pdf>

GET INVOLVED!

TRANSMISSION IS ESSENTIAL FOR RENEWABLE ENERGY DEVELOPMENT AND FUTURE ECONOMIC OPPORTUNITY IN RURAL AREAS.

DOING IT THE RIGHT WAY REQUIRES YOUR HELP. TO LEARN MORE OR GET INVOLVED, VISIT OUR CLEAN ENERGY TRANSMISSION DATABASE AT CFRA.ORG/CLEAN-ENERGY.



SEE TRANSMISSION LINE MAP ON NEXT PAGE

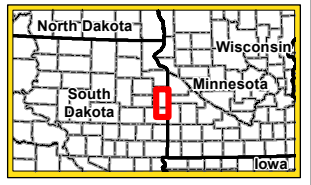
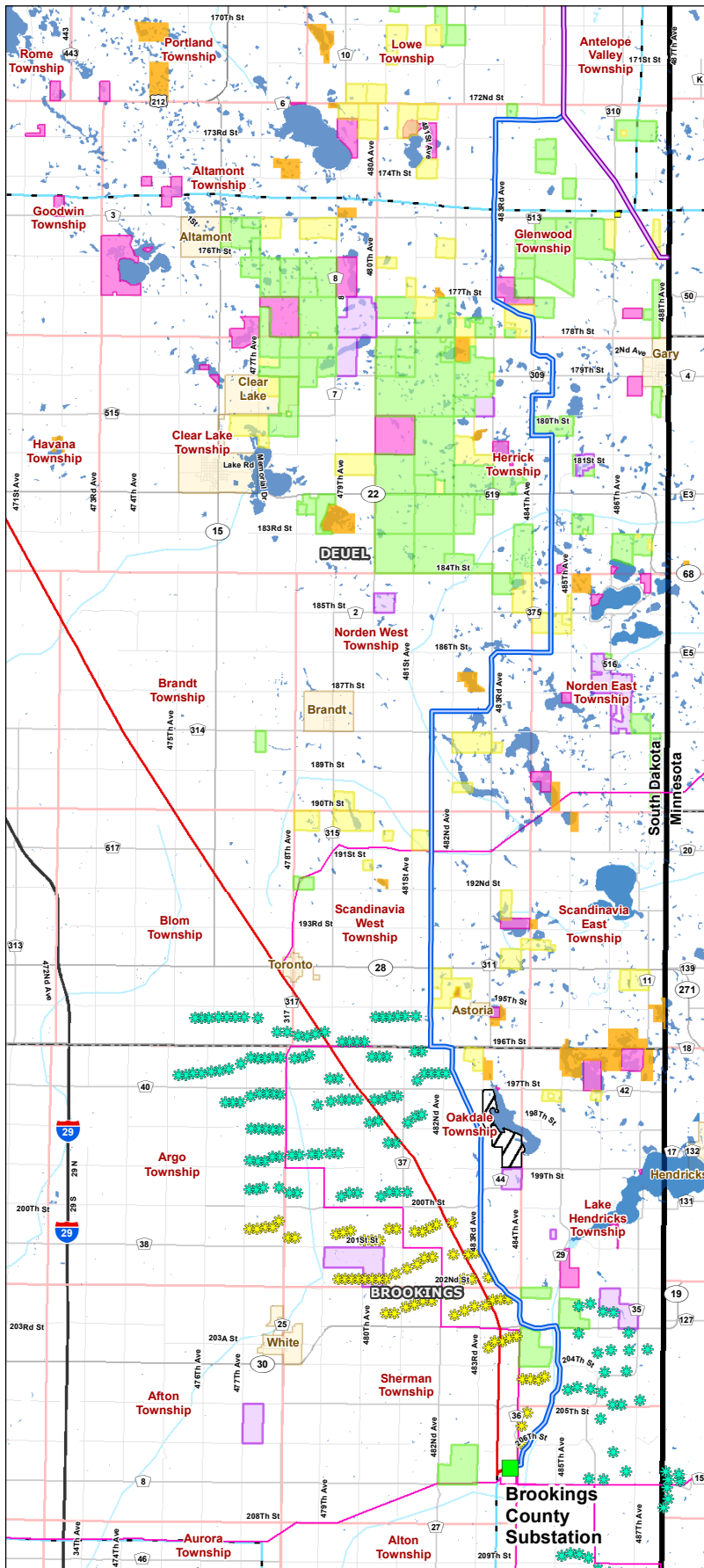

- Legend**
- Project End Point
 - Proposed Route
 - SDPUC Certificated Route
 - Municipal Boundary
 - Township Boundary
 - County Boundary
 - ✪ Existing Wind Turbine
 - ✪ Permitted Wind Turbine
 - USFWS Waterfowl Production Area
 - USFWS Conservation Easement
 - USFWS Grassland Easement
 - USFWS Wetland Easement
 - State Game Production Area
 - SDSU Research Station
 - Lake
- Existing Transmission Line**
- 345 (kV)
 - 230 (kV)
 - 115 (kV)

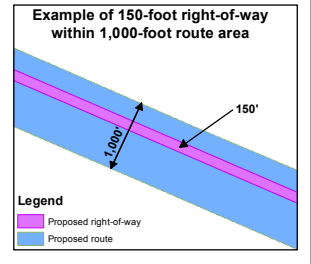
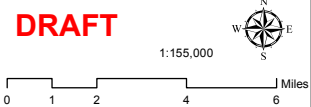

Big Stone South to Brookings County Substation Proposed Route

DRAWN BY: MLTEICHERT DATE: 07/02/13

K:\a\0159818_Big_StoneGIS\MapX2012\121118\Map_CapX\Proposed_Route_Southern_11.mxd